

A blend of modern and colonial design with open storage and U cut drawers.



Shown with supplied hardware.  
Holes pencil marked for installation.



2 Soft Close Drawers with U Cuts



Lower open shelf for enhanced storage



Corner detail

On Timeless vanities, holes are not pre-drilled...

...allowing you to install your choice of hardware for a contemporary or transitional look.



\*Chrome Pulls – 4" - 8"



\*White Marble Pulls – 4" - 8"

Ceramic Vanity Tops\*\*



Black



White

Outline Dimensions

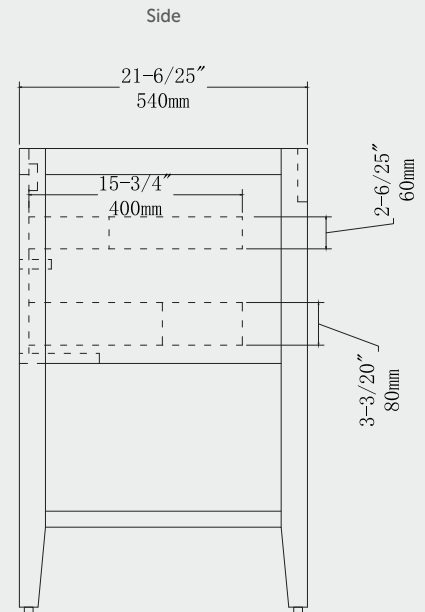
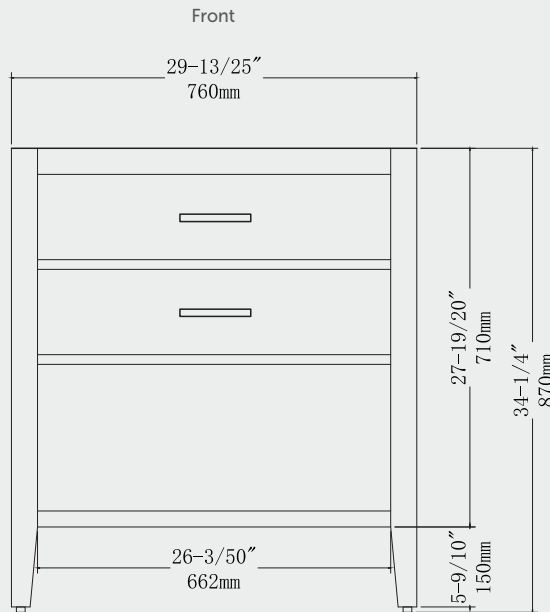

Item Code	Item Description
TM-V3022-PBLK	Timeless 30" Vanity - Pearl Black
TC-3122-WH1	Ceramic 31" White Vanity Top w/Intergral Bowl/Sink - Single Hole
TC-3122- BLK1	Ceramic 31" Matt Black Vanity Top w/Intergral Bowl/Sink - Single Hole